



1 Apartment Type 2AK
1 : 100
- 2 BED, 4 PERSON APARTMENT
- NET INTERNAL AREA (NIA) Areas shown in plan
- GROSS INTERNAL AREA (GIA) : 73.36sqm



2 Apartment Type 2AL
1 : 100
- 2 BED, 4 PERSON APARTMENT
- NET INTERNAL AREA (NIA) Areas shown in plan
- GROSS INTERNAL AREA (GIA) : 81.1sqm



3 Apartment Type 2AM
1 : 100
- 2 BED, 4 PERSON APARTMENT
- NET INTERNAL AREA (NIA) Areas shown in plan
- GROSS INTERNAL AREA (GIA) : 80.61sqm



4 Apartment Type 2AN
1 : 100
- 2 BED, 4 PERSON APARTMENT
- NET INTERNAL AREA (NIA) Areas shown in plan
- GROSS INTERNAL AREA (GIA) : 94.41sqm

APARTMENT ROOM LEGEND	
[Green Box]	BEDROOM
[Yellow Box]	KITCHEN / DINING / LIVING
[Blue Box]	BATHROOM
[Light Blue Box]	ENSUITE
[Grey Box]	STORE
[Orange Box]	ENTRANCE / HALL
[Light Orange Box]	BALCONY / TERRACE / WINTER GARDEN
[Purple Box]	HP

SYMBOL LEGEND	
[Red Arrow]	APARTMENT ENTRANCE
[Wheelchair Symbol]	1200mm x750mm TURNING SPACE



5 Apartment Type 2AO
1 : 100
- 2 BED, 4 PERSON APARTMENT
- NET INTERNAL AREA (NIA) Areas shown in plan
- GROSS INTERNAL AREA (GIA) : 81.18sqm



6 Apartment Type 2AP
1 : 100
- 2 BED, 4 PERSON APARTMENT
- NET INTERNAL AREA (NIA) Areas shown in plan
- GROSS INTERNAL AREA (GIA) : 81.22sqm



7 Apartment Type 2AQ
1 : 100
- 2 BED, 4 PERSON APARTMENT
- NET INTERNAL AREA (NIA) Areas shown in plan
- GROSS INTERNAL AREA (GIA) : 78.68sqm



8 Apartment Type 2AR
1 : 100
- 2 BED, 4 PERSON APARTMENT
- NET INTERNAL AREA (NIA) Areas shown in plan
- GROSS INTERNAL AREA (GIA) : 80.52sqm

Rev	Date	Description	Issued By
P04	28/03/2022	ISSUED FOR PLANNING	EB
P03	25/03/2022	ISSUED FOR PLANNING	EB
P02	08/10/2021	ISSUED FOR PRE-PLANNING	EB
P01	27/09/2021	ISSUED FOR REVIEW	EB

Project Stage
PLANNING

Client:
Tiznow Property Company Limited
(Comer Group Ireland)

Project:
City Park Development
at the Former Tedcastles Site,
Centre Park Road, Cork

Drawing Title:
APARTMENT TYPES - SHEET 7 OF 11

Drawn	Checked	Paper Size	Scale	Date
VF	EB	A1	1 : 100 @A1	02/21/22

Project No.	Drawing No.	Classification	Revision
PE21055	5012		P04

File Name:
PE21055-CWO-ZZ-ZZ-DR-A-5012

Status:
A1 - Authorized and accepted for planning stage



9 Apartment Type 2AS
1 : 100
- 2 BED, 4 PERSON APARTMENT
- NET INTERNAL AREA (NIA) Areas shown in plan
- GROSS INTERNAL AREA (GIA) : 81.98sqm



10 Apartment Type 2AT
1 : 100
- 2 BED, 4 PERSON APARTMENT
- NET INTERNAL AREA (NIA) Areas shown in plan
- GROSS INTERNAL AREA (GIA) : 83.99sqm



11 Apartment Type 2AU
1 : 100
- 2 BED, 3 PERSON APARTMENT
- NET INTERNAL AREA (NIA) Areas shown in plan
- GROSS INTERNAL AREA (GIA) : 64.68sqm

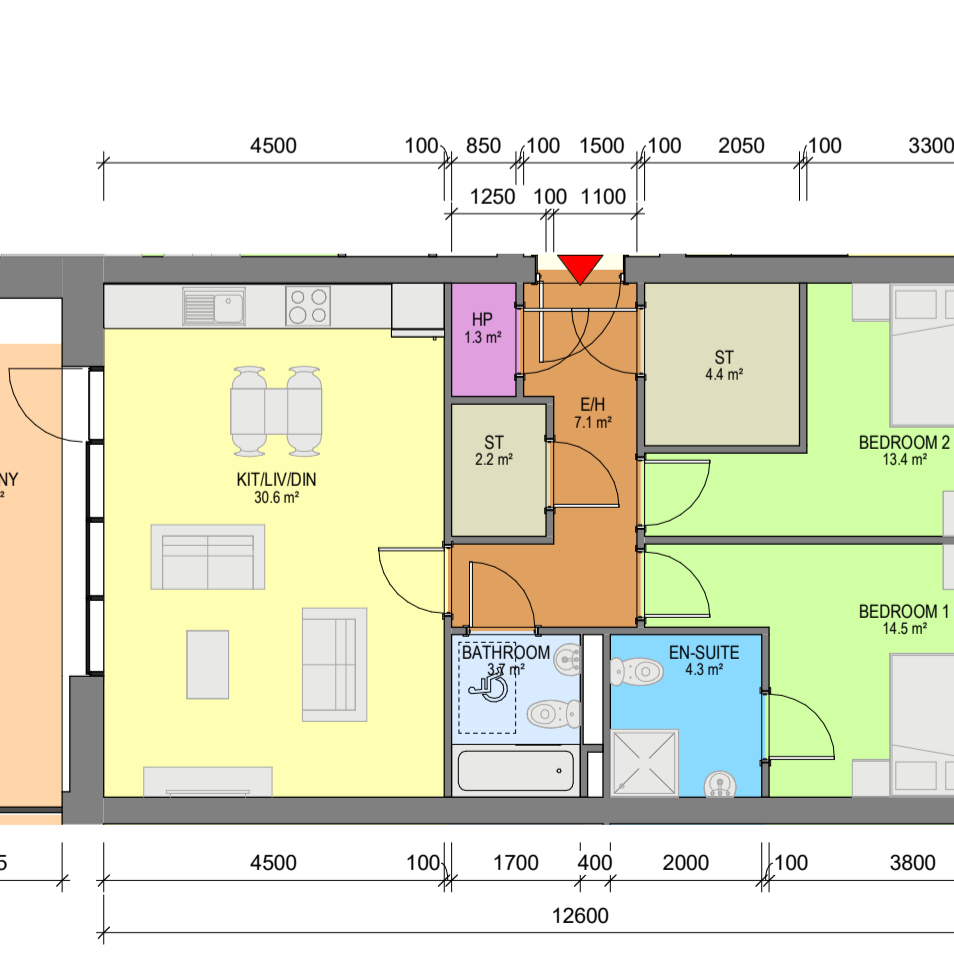

12 Apartment Type 2AV
1 : 100
- 2 BED, 4 PERSON APARTMENT
- NET INTERNAL AREA (NIA) Areas shown in plan
- GROSS INTERNAL AREA (GIA) : 85.68sqm